



GE ACOUSTICS
SCREENS



GE ACOUSTICS

SOUND ABSORBING PANELS



The workplace and the way we work are constantly evolving. We are continually required to create new spaces within existing environments with an increasing demand on sound absorbency.

To meet this demand, GE Acoustics are available as a range of sound absorbing wall mounted or ceiling hung tiles. The hand crafted nature or the manufacturing of GE Acoustics allows any shape or size to be created, leaving no limitation to the product, only your imagination.

SOUND ABSORBENCY

The Noise Reduction Coefficient (commonly abbreviated NRC) is a scalar representation of the amount of sound energy absorbed upon striking a particular surface. An NRC of 0 indicates perfect reflection; an NRC of 1 indicates perfect absorption.

Typically, as sound hits a solid surface, it will be reflected back. This means, in a room with an NRC rating of 0, that all sound produced will be reflected. This can be improved with the addition of sound absorbing tiles.

With the addition of sound absorbing tiles, the reverberation time can be decreased therefore resulting in the overall noise being reduced. This can help in improving staff concentration levels and decreasing interruptions.

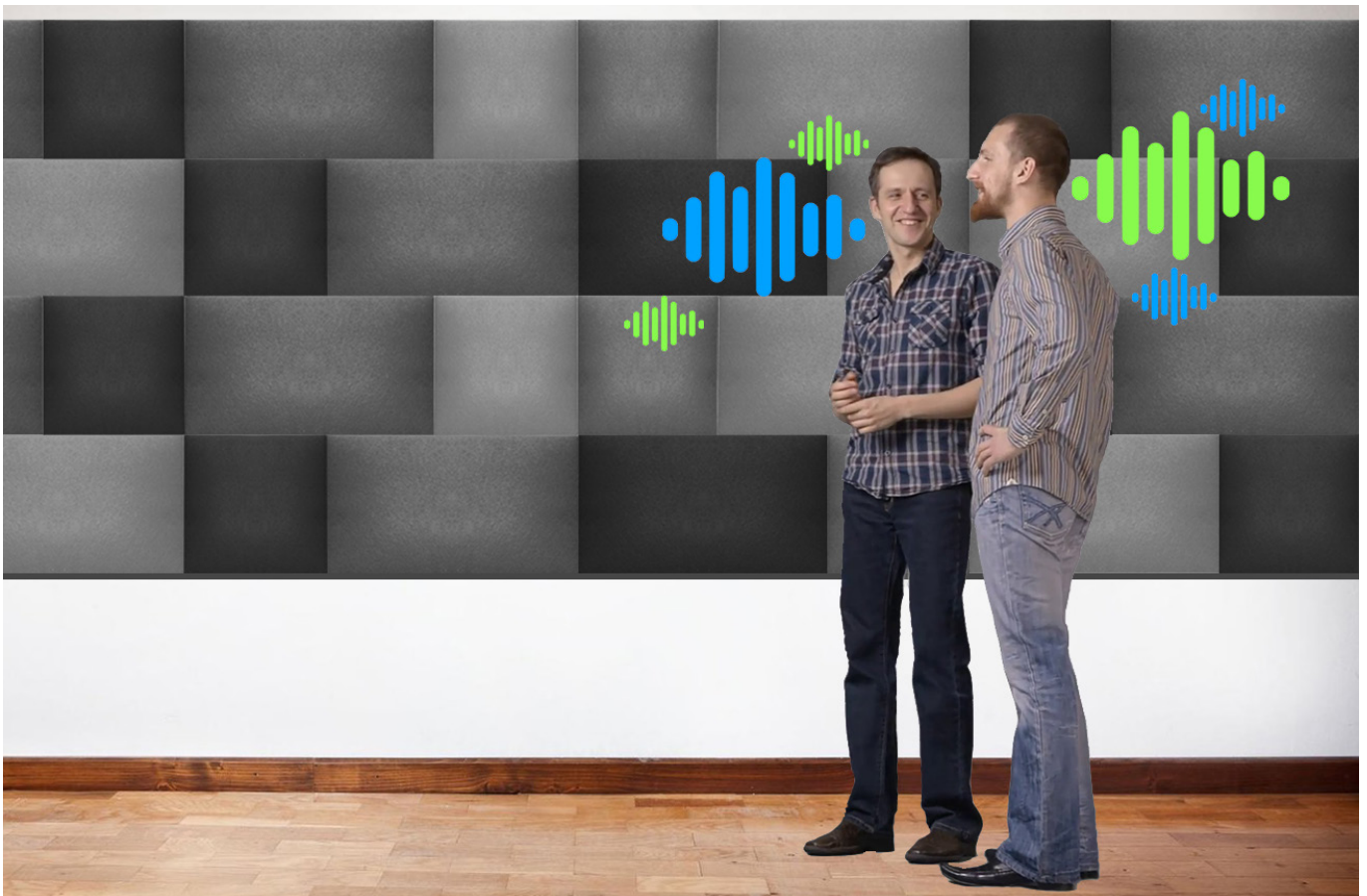

Measurement of Sound Absorption in accordance with BSEN ISO 354:2003
(Test report number C/23213/T01)

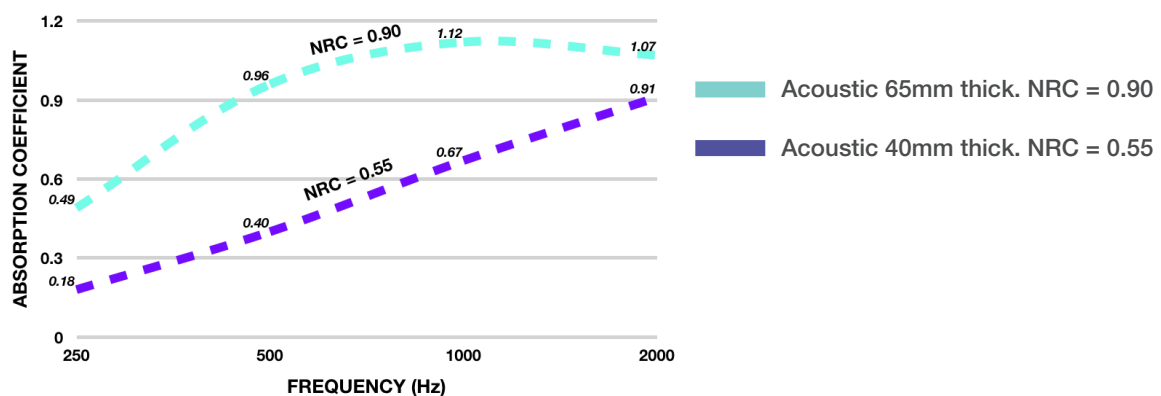

CASE STUDY

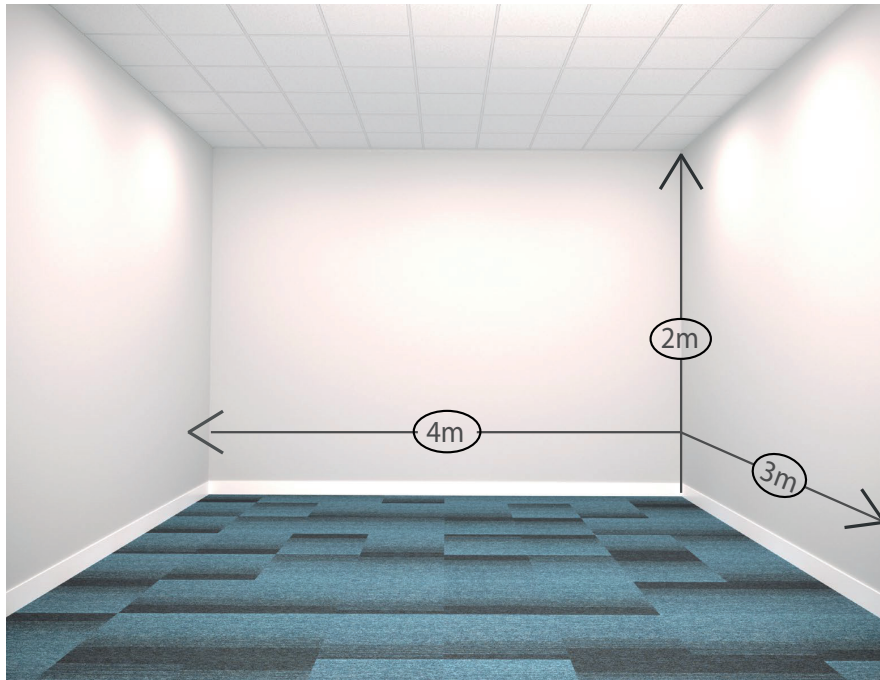

The room shown above, when empty, will have a reverberation time of 1.15 seconds, this means that it will take 1.15 seconds for the sound to decay by 60 decibels. This reverberating sound could disrupt staff.

By incorporating 5 square meters of 40mm thick sound absorbing tiles into this room, which have an NRC rating of 0.55, the reverberation time would be reduced to 0.76 seconds or a reduction of 34%.*

Similarly, by incorporating 5 square meters of 65mm thick sound absorbing tiles into this room, which have an NRC rating of 0.90, the reverberation time would be reduced to 0.67 seconds or a reduction of 42%.*

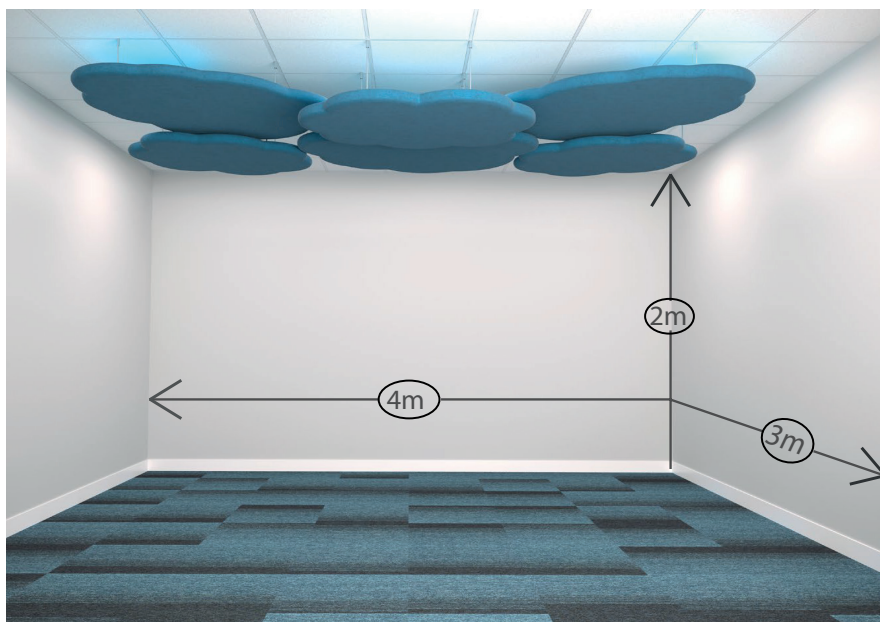

*Case study results were calculated by KP Acoustics.

CLOUD

Many office ceilings can be plain and lack colour and consideration. Cloud ceiling tiles can be hung from most ceilings or suspended ceiling grids and will absorb unwanted sound while also providing shape, colour and design. Tiles can be fitted at adjustable distances from ceilings providing flexibility and opportunities to overlap creating organic configurations.



THUMBNAILS



GE11A

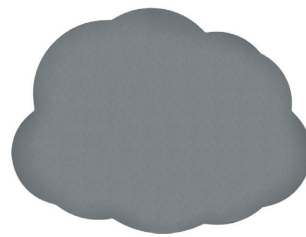

GE11B

CIRCLE

Many office ceilings can be plain and lack colour and consideration. Circle and Doughnut ceiling tiles can be hung from most ceilings or suspended ceiling grids and will absorb unwanted sound while also providing shape and colour. Tiles can be fitted at adjustable distances from ceilings providing flexibility and opportunities to overlap creating organic configurations.



THUMBNAILS



GE12

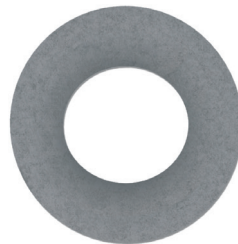

GE13

SQUARE (CEILING GRID)

Many ceiling grids are plain & lack colour. Square ceiling tiles replace existing tiles in the grid to absorb unwanted sound and add colour to the office. All or some of the tiles can be swapped to create organic, unique patterns.



THUMBNAILS



GE25A1

SQUARE / RECTANGLE

With limited floor space available in offices, empty walls or vertical surfaces can be used to absorb unwanted noise to help staff concentrate. By using Square & Rectangle wall tiles, colours, patterns, texture, shape and tessellation can be introduced to otherwise plain and commonly white spaces while providing the dual function of sound absorption. Supplied with simple Velcro fixings which are flexible, consider covering not just walls, but cupboard backs, doors and pillars.

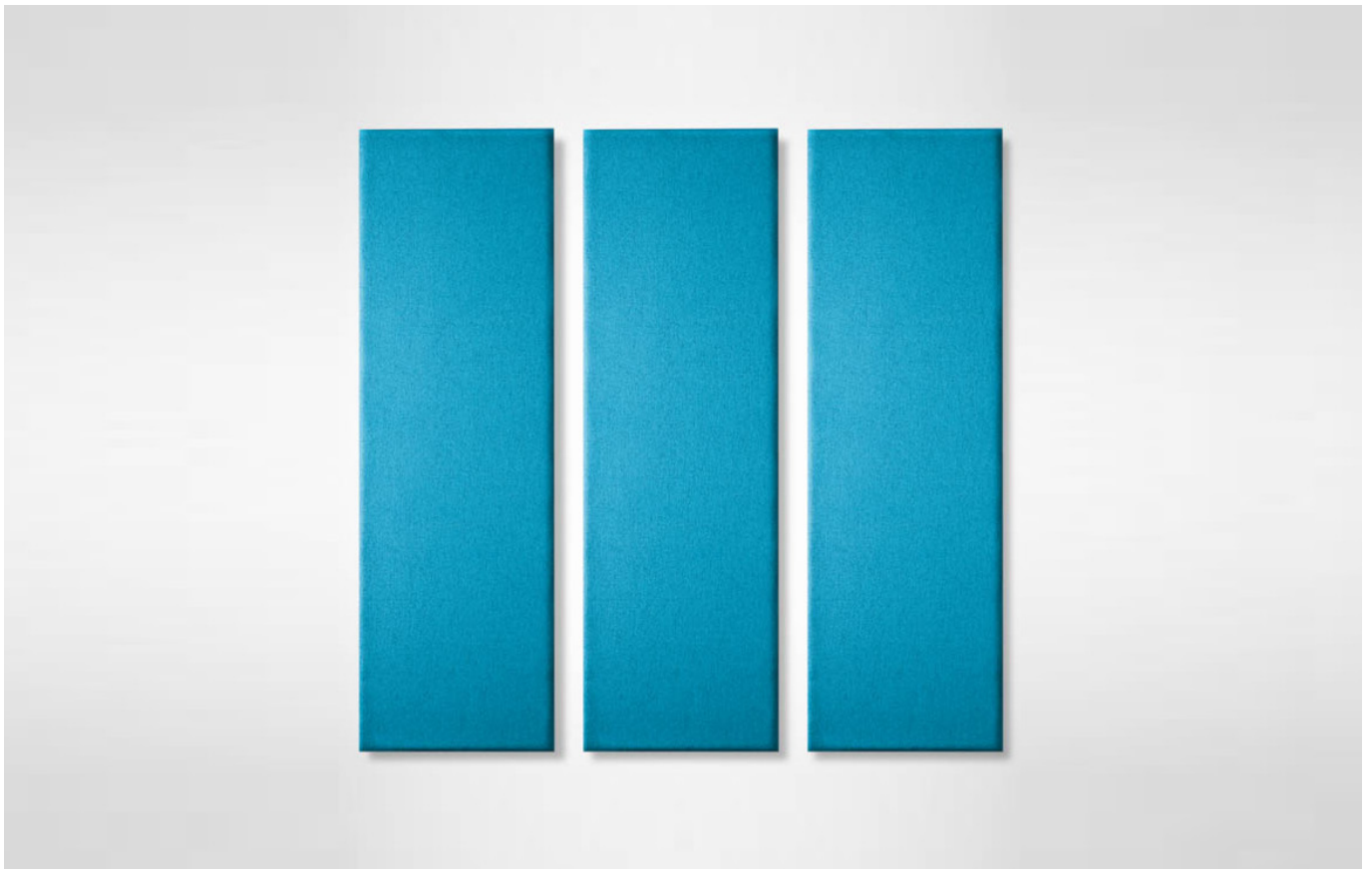

THUMBNAILS



GE14



GE15

APEX

With limited floor space available in offices, empty walls or vertical surfaces can be used to absorb unwanted noise to help staff concentrate. By using Apex 3D wall tiles, colours, patterns, texture, shape and tessellation can be introduced to otherwise plain and commonly white spaces while providing the dual function of sound absorption. Supplied with simple Velcro fixings. Can also be ceiling hung (please contact our Sales Department).

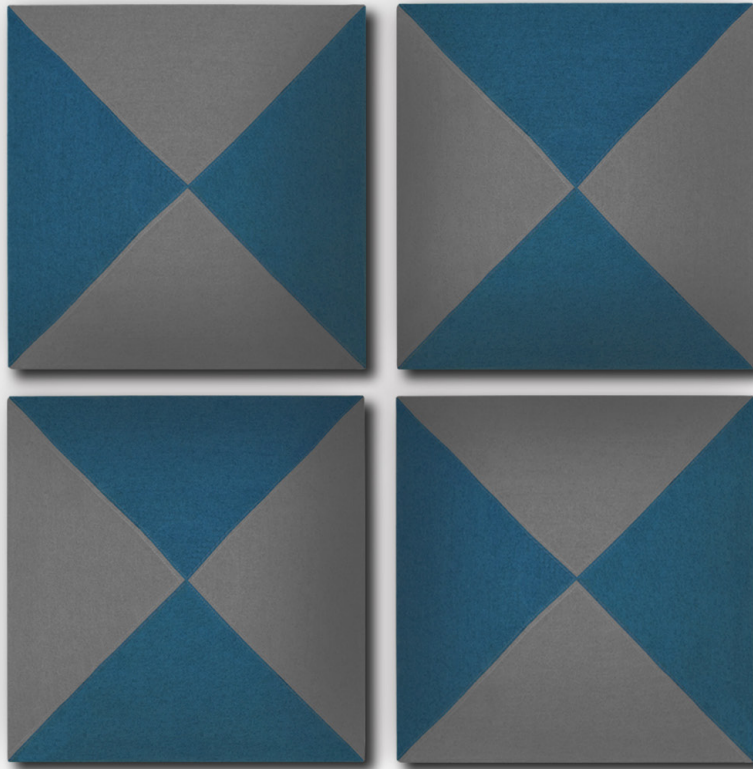

THUMBNAILS



GE16



GE24

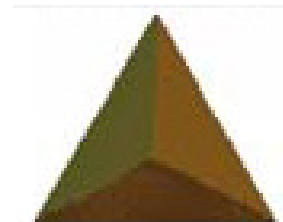

GE18

ARROW

With limited floor space available in offices, empty walls or vertical surfaces can be used to absorb unwanted noise to help staff concentrate. By using Arrow wall tiles, colours, patterns, texture, shape and tessellation can be introduced to otherwise plain and commonly white spaces while providing the dual function of sound absorption. Supplied with simple Velcro fixings which are flexible, consider covering not just walls, but cupboard backs, doors and pillars.



THUMBNAILS

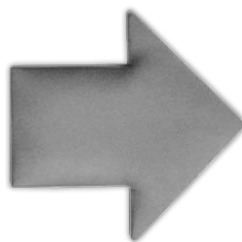

GE19

HEXAGON

With limited floor space available in offices, empty walls or vertical surfaces can be used to absorb unwanted noise to help staff concentrate. By using Hexagon wall tiles, colours, patterns, texture, shape and tessellation can be introduced to otherwise plain and commonly white spaces while providing the dual function of sound absorption. Supplied with simple Velcro fixings which are flexible, consider covering not just walls, but cupboard backs, doors and pillars.



THUMBNAILS



GE20A



GE20B



GE20C

SPECIFICATION

FABRIC OPTIONS

Camira Cara
Camira Era
Camira Carlow
Camira Blazer Lite
Camira L2
Camira Sonus
Camira Racer

Camira Blazer
Camira Synergy
Camira Aspect
Camira Patina
Camira X2
Camira Canopy

MOUNTING OPTIONS



Wall Mounting Velcro

Rectangle
Apex
Arrow
Hexagon



Ceiling Hanging Wire

Cloud
Circle

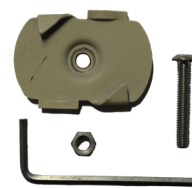

Suspended Ceiling Grid Clip

Cloud
Circle



NEED IT DIGITAL?

Visit our brand new website which features
High Resolution Imagery, Specification Sheets
and CAD Blocks of all our Ranges.

www.gof.co.uk



